

Available

For Lease

Up to 5021 Square Feet
Ecumen Office Building

*3530 Lexington Avenue North
Shoreview, MN*



Property Highlights:

- 5,021 square feet total
- Divisible
- First floor location
- Directly off front lobby
- Good glass line
- Ample parking
- Tax exempt

Exclusively Marketed by:
Sherman Malkerson

Phone: 952-525-1635
Email: smalkerson@cchaseco.com

The C. Chase Company
5353 Gamble Drive, Suite 310
Minneapolis, MN 55416-1509

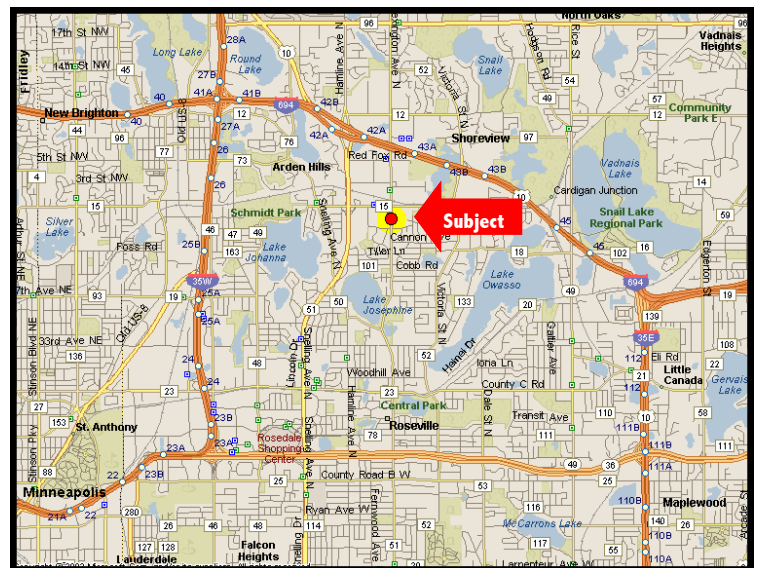

The C. Chase Company
CORFAC INTERNATIONAL

CORFAC
International

Information contained herein has been obtained from the owner of the property or from other sources that we deem reliable. We have no reason to doubt its accuracy, but we do not guarantee it.