

Available

For Sale
8,089 Square Foot
2 Bay Corporate Airport Hangar
Anoka County Airport
9444 Lima Street
Blaine, MN



Exclusively Marketed by:

David J. Bruce
Sherman Malkerson
Kyle Malkerson

Phone: 952-525-1000

Fax: 952-525-1335

Email: dbruce@cchaseco.com

smalkerson@cchaseco.com

kmalkerson@cchaseco.com

The C. Chase Company
5353 Gamble Drive, Suite 310
Minneapolis, MN 55416-1509

Property Highlights:

- Two bays of 3,828 SF each plus second floor office of 433 SF
- Total office area of 757 SF
- Full kitchen, toilet with shower
- Epoxy coated floors
- 16' 6" x 59' bi-fold doors in each bay
- Insulated metal walls
- Private parking lot for 10 cars
- Priced at \$305,000

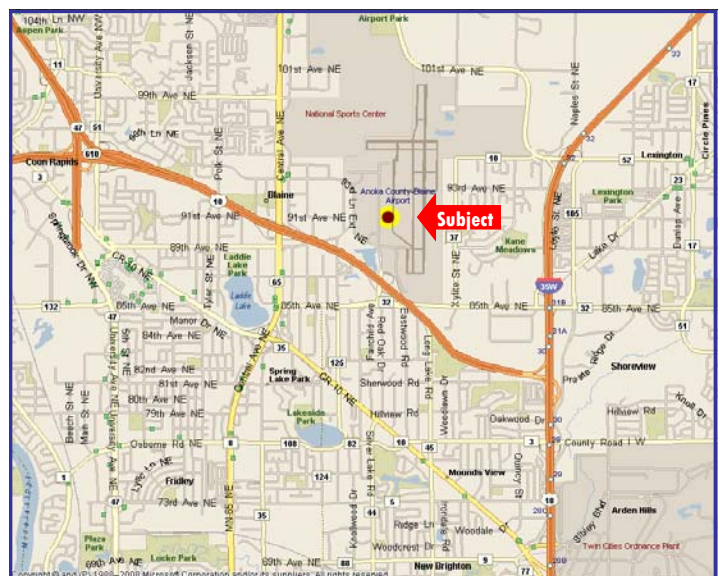

The C. Chase Company
Real Estate Brokerage and Consulting

Information contained herein has been obtained from the owner of the property or from other sources that we deem reliable. We have no reason to doubt its accuracy, but we do not guarantee it.



Kitchen



Office



Office



Office



Interior—South Bay



Hangar Plus Vehicle Parking

Information contained herein has been obtained from the owner of the property or from other sources that we deem reliable. We have no reason to doubt its accuracy, but we do not guarantee it.

FOR SALE
TWO BAY CORPORATE HANGAR
ANOKA COUNTY AIRPORT
BLAINE, MN

Address: 9444 Lima Street
Blaine, MN 55014

Land Area: 11,023± SF

Building Size:

Bay 1:	3,828 SF
Bay 2:	3,828 SF
Second Floor Office:	<u>433 SF</u>
Gross Building Area:	8,089 SF

Building Age: 11 years (1998)

Construction:

- Wood frame
- Metal interior and exterior walls and ceiling and roof
- Insulated walls and ceiling.
- Concrete, epoxy coated floors

HVAC:

- Central air and heat for office, toilet and kitchen areas
- Radiant heat for hangar bays

Power: 200 amps

Ceiling Height: 18' 3" clear

Amenities:

- City sewer and water
- Full kitchen
- Shower in toilet room

Parking: Private lot, 3298 SF; parking for 10 cars

Sale Price: \$305,000

For further information:

The C. Chase Company
5353 Gamble Drive, Suite 310
Minneapolis, MN 55416

Dave Bruce
952-525-9644
dbruce@cchaseco.com

Sherman Malkerson
952-525-1635
smalkerson@cchaseco.com

Kyle Malkerson
952-746-5341
kmalkerson@cchaseco.com

